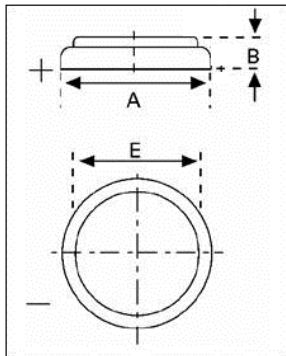

Data Sheet

Type Number	6032
Designation IEC	CR 2032
System	Li-Manganese dioxide / Organic Electrolyte
UL Recognition:	MH 13654
Nominal Voltage	3 V
Typical Capacity C	220 mAh
Load 5.6 kOhm, at 20°C down to 2 V	
Weight (approx.)	3 g
Volume	0,95 ccm
Coding	Date of Manufacturing DWWY

Temperature Ranges	min	max.
Storage	-55°C	70°C
Discharge	-20°C	70°C *

Dimensions	min	max.
Diameter (A)	19,7	20,0
Height (B)	2,9	3,2
Shoulder Diameter (E)	16,0	

Segment Electronic

Main Applications Watches
Digicams
Electronics

Typical Capacities (at 20°C)

Discharge Type	Load	End Voltage:	2.0 V
Continuous 24h/d,7d/w	5600 Ω	Time:	430 h
		Capacity [mAh]:	220
		Energy [mWh]:	610

* Contact VARTA if the application is intended to be outside the range of -20°C to +70°C.

Data Sheet

Performance Data:

• **Temperature Characteristics**

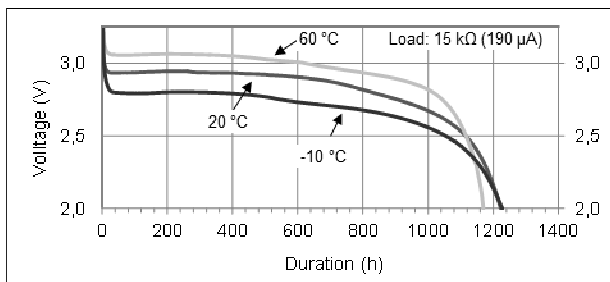

• **Operating Voltage vs. load resistance ***

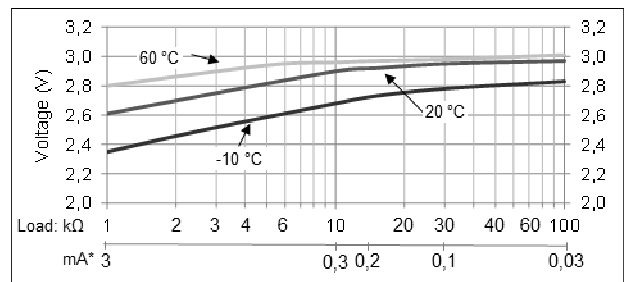

* Voltage at 50% discharge depth

• **Capacity vs. load resistance**

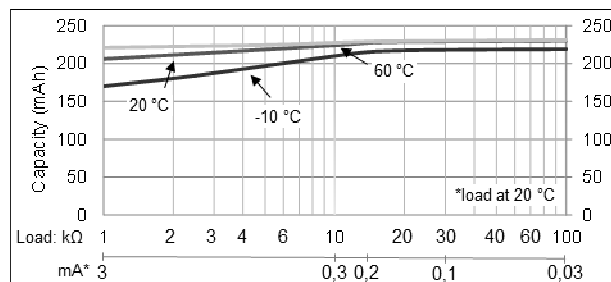

- Self-discharge rate < 1% at room temperature
- Storage life > 10 years
- Operating life* > 10 years

* depending on environmental conditions and energy consumption